

Einbauanleitung installation instruction

Art.-Nr.:
item#

08363x Toyota Verso S ab 03/2011



Verkleidung lösen und anheben
Bitte benutzen Sie nur ein Kunststoff-Werkzeug!



Loosen and lift cover
Please use only plastic tools!

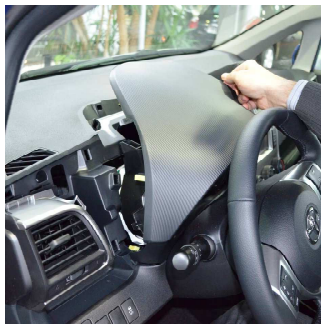

Verkleidung lösen und anheben



Loosen and lift cover

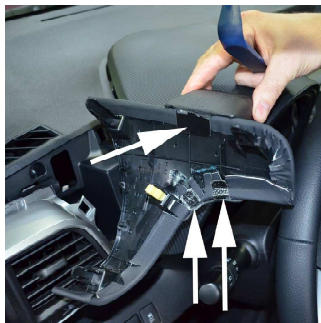

Konsole wie abgebildet positionieren
Bleche umbiegen



Position console as illustrated
Bend metal plates

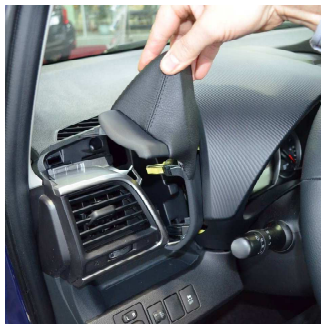

Verkleidung mit der Konsole wieder montieren



Reinstall cover together with console

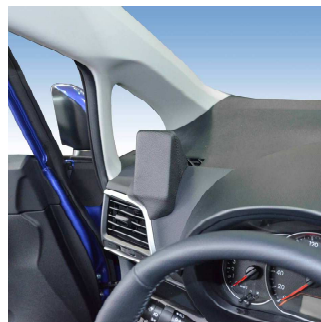

Alle Bauteile wieder montieren



To remount all component parts

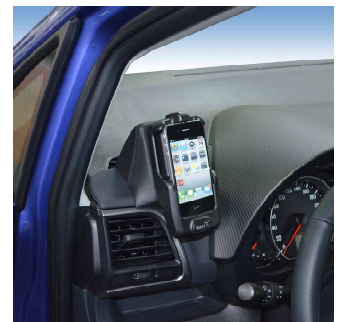

Änderungen vorbehalten Subject to change

Kuda-Phonebase GmbH

Industriestraße 16
D-49401 Damme

tel: +49 5491 9695 -0
fax: +49 5491 9695 -30

eMail: info@kuda-phonebase.de
net: www.kuda-phonebase.de

Instructions d'installation

instrucciones de instalación

Art.

08363x

Toyota Verso S ab 03/2011

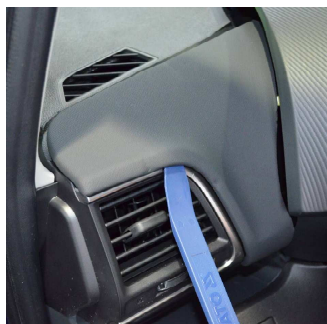

Desserrez et soulevez la couverture
Veuillez n'utiliser qu'un outil de matière plastique



Suelte y levante revestimiento
Use sólo herramientas de plástico!

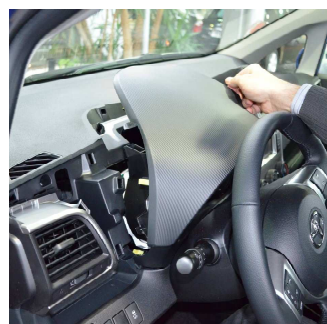

Desserrez et soulevez la couverture



Suelte y levante revestimiento

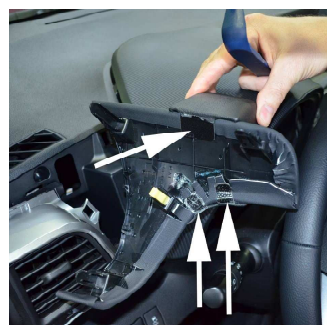

Positionnez la console comme illustré
Tirez les tôles



Posicione la consola como mostrado
Tuerza las chapas

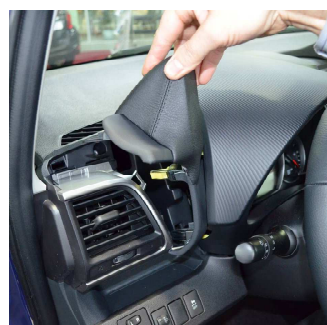

Réinstallez le revêtement avec la console



Reinstale el revestimiento junto con la consola



Remontez les éléments de construction



Remonte todos partes de construcción



Nous nous réservons la possibilité de modification

Salvo posibles modificaciones

Kuda-Phonebase GmbH

Industriestraße 16
D-49401 Damme

tel: +49 5491 9695 -0
fax: +49 5491 9695 -30

eMail: info@kuda-phonebase.de
net: www.kuda-phonebase.de

07.03.2012

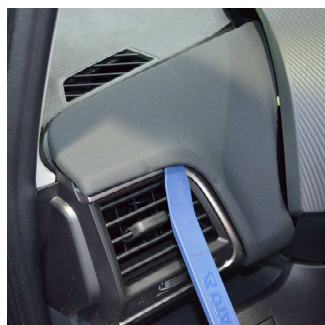

Bekleding losmaken en optillen
Alleen plastic gereedschap gebruiken alstublieft!



Tapicerke poluzuj i podnies
Prosze uzywac tylko narzedzi z tworzywa sztucznego.

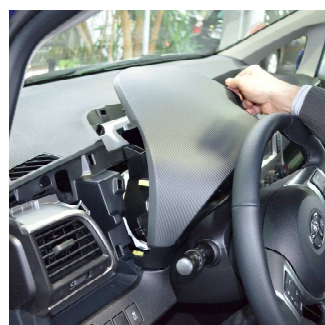

Bekleding losmaken en optillen



Tapicerke poluzuj i podnies

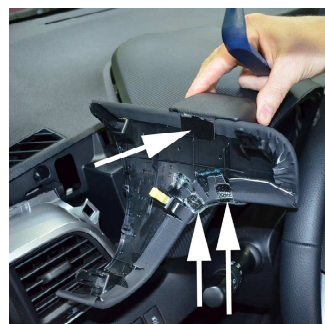

Konsole zoals afgebeeld positioneren
Metalen plaat ombuigen



Uchwyt umiescic jak na przedstawionym zdjeciu.
Blaszki zagiac

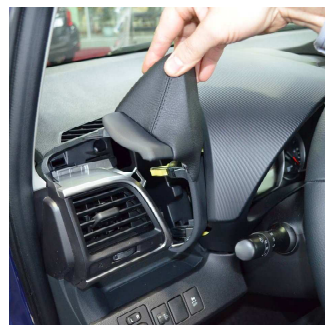

Bekleding met het console terug monteren



Oslone z konsola ponownie zamontowac



Alle gedemonteerde delen weer monteren



Wszystkie elementy ponownie zamontowac

